

Product Brochure For K058C

Hydraulic NC Pressbrake & NC Guillotine Package Deal - PB-135B & SG-2504E

Pressbrake 135T x 3200mm, Guillotine 2500 x 4mm

Pressbrake Estun NC-E21 Control, Guillotine Ezy-Set NC-89 Control



ORDER CODE:	K058C
MODEL:	PB-135B & SG-2504E
Control Unit (Type):	Estun NC-E21 & Ezy-Set NC-89
Nominal Pressure - Tonnage (Ton):	135
Nominal Pressure - Kilonewtons (kN):	1250
Length of Work Table (mm):	3200
Distance Between Columns (mm):	2650
Throat Depth (mm):	415
Maximum Open Height (mm):	390
Ram Stroke (mm):	130
Machine Axis (No.):	2
Safety Guarding System (Type):	Light Curtain System
Backgauge Travel (mm):	520
Table Bed Crowning System (Type):	-
Motor Power (kW / hp):	7.5 / 10 & 5.5 / 7.5
Motor Voltage (V):	415
Floor Space Requirements (L x W x H) (mm):	-
Nett Weight (kg):	12000



Description

MetalMaster Quality Pressbrakes feature high durability, and provide precision bending capabilities. The Pressbrake main frames are constructed from rolled, stress relieved solid steel to prevent distortion during the bending process and under extreme continuous loads.

MetalMaster Pressbrakes are produced in a high volume production process and therefore are able to be manufactured cost effectively, resulting in affordable price, representing value for money and quicker return on investment.

Featuring an adjustable synchronised torsion bar with positive stop system ensures consistent and accurate bending beam parallelism tolerance to 0.01mm via the digital Control unit.

All electrical components are of European quality supplied by, Telemecanique, Merlin Gerin and ABB.

Features

- PB-135B - Hydraulic NC Pressbrake
- Hydraulic / Mechanical ram, synchronised positive stop design, ram stroke controlled by precision mechanical nut depth stops built into each cylinder. Electronically controlled by Estun NC-E21 Programmable digital control assuring accurate repeatability.
- Parallelism is ensured by torsion bar that can be easily adjusted by clutch system.
- Estun NC-E21 programmable digital control stores up to 40 unique programs with 25 automatic progressive bending steps in each individual program, assuring production accuracy & repeatability every time.
- Estun NC-E21 programmable hardened ballscrew backgauge system, simply enter the desired measurement into the controller and press go, the backgauge then will move quickly into the position you have requested. The superior hardened ballscrew system eliminates any backlash that leadscrew type machines produce.
- Segmented heavy duty 86° offset top punch is segmented for return bend clearance, complete with European style punch holder with an adjustable wedge clamping system for crowning.
- Intermediate clamp has safety key to stop punch dropping.
- Multi vee ('V') bottom die is made from one 3200mm solid die block design to handle heavy plate, safety edge vee ('V') is incorporated in bottom die block.
- Conveniently mounted control box on pendant for quick swivel and adjustments.
- Mono-block steel frame design, welded then machined to ensure minimal bed deflection under load
- Enclosed rear gate with micro safety switches complete with sliding rear door for easy access.
- European Intermediate clamping system, allowing operator to change position of tooling to suit multiple requirements on complex applications. This feature ensures minimum down time, more productivity and results in reduced cost per finished product.
- Sliding steel fabricated sheet supports enabling a wide range of material sizes to be aligned and supported at the correct required height. This feature is achieved with a "T" slot machined down the total length of the die bed, sheet supports are also adjustable vertically to assist in supporting material with return bends already folded.

Product Brochure For K058C

- Adjustable sliding blocks control the machines beam to provide desirable open height distance to the (slow speed) mute bending point.
 - Operator adjustable locking knobs for quick adjustment, enables accurate repeatability and increased productivity.
 - Metal safety guarding surrounding the machine with rear sliding door fitted and micro switch ensuring operator safety.
 - Clear access panels placed at each end of machine allows the operator to clearly view tooling and work piece during bending operation.
 - MetalMaster specially design gates to suit Australian safety requirements.
 - Hydraulic MPA pressure gauge mounted on right side of support frame with quick adjusting pressure control knob allowing operator to accurately set the pressure required for different material thickness, incorporating with hydraulic overload protection.
 - Welded steel fabricated synchronised torsion bar horizontally supporting main bending beam to provide consistent parallelism that also can be adjusted for taper correction.
 - The vertical supporting slides are treated to provide greater ware resistance and increased accuracy.
 - Reinforced side frames providing addition support strength to machine throat.
 - Includes safety control guarding system with light curtains fitted
 - Mild steel capacity is rated on hot rolled material with 250MPA
- Pre-Commissioning:
 1. Pressbrake is run & tested prior delivery
 2. Hydraulic oil is included with machine
- SG-2504E - Hydraulic NC Swing Beam Guillotine
 - Hydraulic individual sheet material clamping system with nylon inserts to protect material from indentation from the clamping cylinders along full length of machine.
 - Ezy-Set NC-89 Go-To digital display control provides up to 600mm travel via leadscrew backgauge allowing operator to program the cut length required. Also incorporated into NC-89 control is a stroke counter and cut length adjustment allowing shorter materials to be cut quicker without blade cycling through full stroke, this feature will increase production.
 - Blade gap adjusting dial mounted on side of machine for convenient and accurate alteration for all your material thickness from 0.5 - 4mm. This dial is designed so that a straightforward rotation clock or anti clockwise to achieve desired plate thickness. Measurement on dial indicates and refers to actual blade gap distance in millimetres
 - Transfer balls inserted into work table allowing material to be easily moved to the cut position and squaring arm.
 - Top shearing blade made from 6CrW2Si quality composite and has two (2) cutting edges allowing minimised down time in blade rotation.
 - Bottom shearing blade made from 6CrW2Si quality composite and has four (4) cutting edges allowing minimised down time in blade rotation.
 - The core structure of the steel main frame has been electronically welded ensuring maximum penetration during the manufacturing process. In addition to this feature the cutting beam has been stress relieved eliminating any distortion after manufacturing.
 - LED shadow line lighting has been incorporated into the machine frame providing a clear cutting line on the work piece and enabling scribed or marked material to be cut with simplicity as required.
 - Heavy duty squaring arm is fitted with a graduated rule and adjustable flip up front stops and mitre guide allowing operator to cut to the required size from the front of machine. Flip over stops can be set to repeat cutting length required with accuracy. The arm also aligns the material to be located square to the cutting edge.
 - Safety three photo electric rear guards fitted to steel side gates ensuring that the machine will be disabled when person enters rear of machine when in use
 - Safety reset button for guarding system located at rear of machine, this feature requires operator to walk to rear of machine to visually check for any obstruction prior to resetting & starting machine
 - Mild steel capacity is rated on hot rolled material with 250MPA

- Pre-Commissioning:
 1. Guillotine is run & tested prior delivery
 2. Hydraulic oil is included with machine

Includes

- PB-135B - Hydraulic NC Pressbrake
 - Operated by ESTUN NC- E21 control mounted on a swivel pendant for optimal ergonomics
 - LED superior bright work lights provides clearer view to workpiece
 - Sliding front sheet support arms
 - Emergency stop buttons conveniently located on control panel and foot control
 - Mobile dual operation foot control
 - Segmented 86° offset top tooling
 - Solid one piece four way multi vee (V) die block
 - Top tooling tool intermediate holder system with wedge type adjustment
 - Powered hardened ballscrew backgauge with 520mm travel, operated by Estun NC-E21 control
 - Oil tank level indicator
 - Metal constructed safety guarding surrounding machine with clear side viewing panels
 - Integrated hydraulic system allowing rapid approach switching automatically to slow bend
 - Includes safety control guarding system with light curtains fitted
- SG-2504E - Hydraulic NC Swing Beam Guillotine
 - Heavy duty over driven machine construction
 - Rapid blade gap adjustment
 - Emergency stops fitted on both ends of machine for additional safety
 - Individual hydraulic hold downs with nylon pads
 - 100mm throat enables shearing of longer material than 2500mm
 - Shadow line lighting allows operator to quickly see the cut line
 - 600mm Ezy-Set NC-89 Go-To via leadscrew backgauge with fine adjustment
 - Swing away backgauge function for cutting long sheets
 - 4 edge quality 6CrW2Si blades suitable for stainless steel
 - Rexroth hydraulic control valves
 - Schneider electrical components
 - Transfer balls on table & support arms
 - Heavy duty support arms and squaring arms

Product Brochure For K058C

- Stroke counter and short stroke adjustment
- Sliding chute fitted, easily allowing operator to retrieve cut pieces

Includes: Safety Guarding System for OHS Compliance

(S620A + S621B)

FoldSafe Advantages:

1. Australian made genuine Foldsafe Safety Guarding System, manufactured & fitted in Australia.
2. The safest integrated dual redundant curtain system in Australia.
3. 100% Australian design, built and supported locally.
4. Dual e/stops safety gate circuits for maximum operator safety.
5. Encoder speed & stopping performance monitoring will ensure maximum safety in the rare case of hydraulic valve failure.
6. Italian made safety curtains & safety relays with a long protection height of 910mm @10ms.
7. Primary & secondary stop method design, if the primary stop detection fails, the secondary stop is still active monitoring machine ensuring maximum safety.
8. User friendly interface displaying status of machine, no guess work or codes.



Specific Features



Pressbrake



Right View



Left View



Light Curtain Guarding in Use



NC Estun E21 Controller



NC Estun E21



Adjustment Travel Control



Enclosed Rear Safety Guarding

Product Brochure For K058C

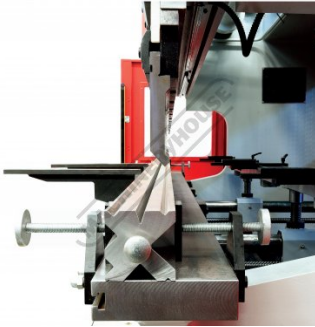

Top Bottom Tooling



Intermediate Clamps



Adjustable and Sliding Front Sheet Supports



Estun NC E21 Control Ballscrew Back Gauge

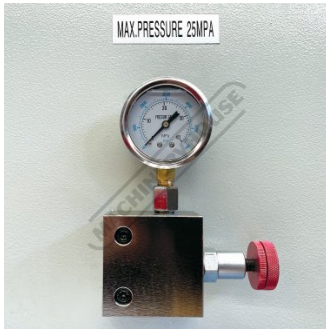

Adjustable Pressure Control



Mobile Foot Control



Mobile Foot Control Top Buttons



Adjustable Top Tool Taper Wedge System

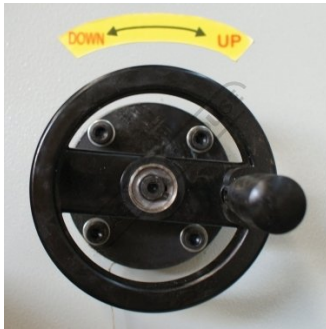

Fine Adjustment Beam Positioning



Fine Adjust Backgauge



Synchronised Torsion Bar



Synchronised Torsion Bar

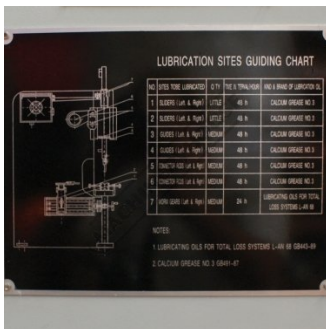

Lubrication Chart

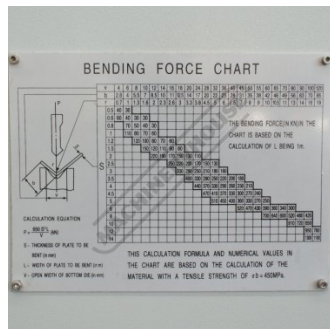

Tonnage Calculation Chart

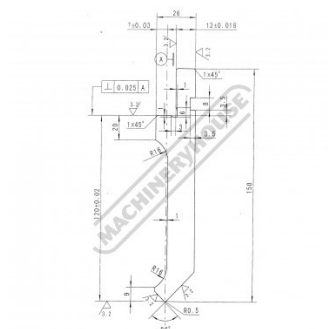

Segmented Top Punch

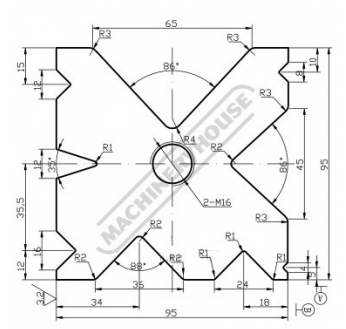

One Piece 4 Sided Die

Product Brochure For K058C



Shown with Optional Ball Transfer Tables - Order Code (L840)



Guillotine



Right View



Squaring Arm



NC89 Control



Material Transfer Balls on the Table



Emergency Stop



Foot Control



Lifting Point



Blade Clearance Adjustment Lever

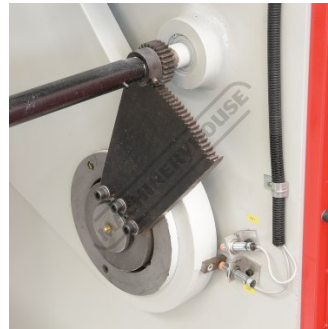

Blade Clearance Adjustment Mechanism

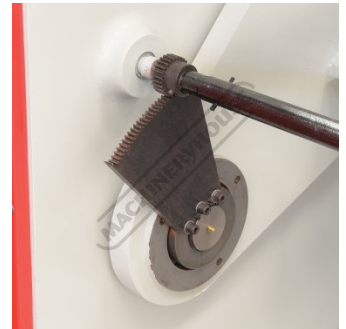

Blade Clearance Adjustment Mechanism Left Side



Rear Guarding View



Rear View



3 x Photo Electric Rear Guarding



Safety Omron E3ZS Rear Light Sensor Guarding

Product Brochure For K058C



Rear Guard Rest Button



System Pressure



Return Pressure



NC Leadscrew Backgauge

Recommended Accessories

S993

95mm Die Block Pressbrake Tooling

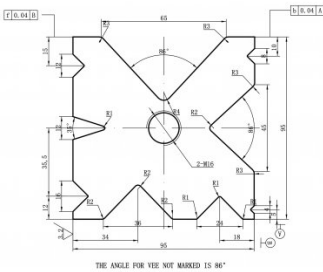

S991

86° Top Punch Pressbrake Tooling



S991F

86° Top Punch Pressbrake Tooling



S996

15° Top Punch Pressbrake Tooling



S996A

60mm Die Block Pressbrake Tooling

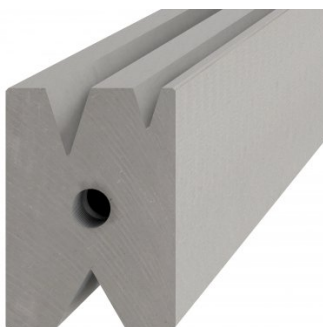

S996B

60mm Die Rail Pressbrake Tooling



S988

Quick Action Intermediate Clamps



Q200

Combination Set

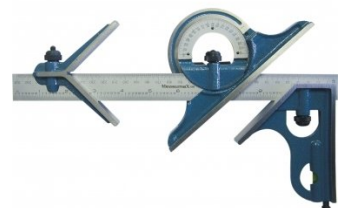

Product Brochure For K058C

Q200A
Combination Set

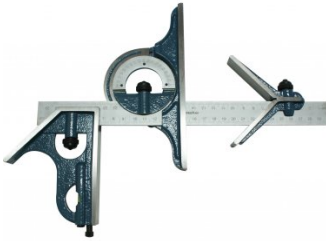

Q201
Universal Bevel Protractor



Q2105
Digital Height Gauge



M970
Digital Angle Rule

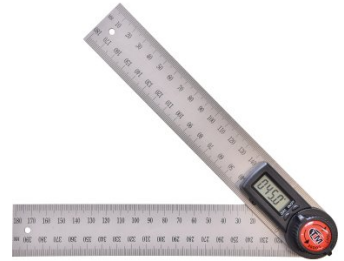

M972
Digital Angle Rule



M974
Digital Angle Rule



M800
Rubber Mat - Anti-Fatigue



M805
Rubber Mat - Anti-Fatigue

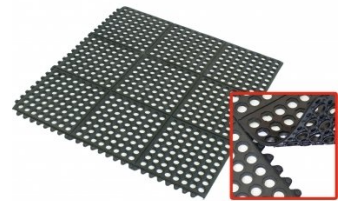

O000
SpillFix Universal Organic Absorbent



O043
Rust & Corrosion Preventive



O042
General Purpose Lubricant & Corrosion Inhibitor



O040
Rust & Corrosion Preventive



Product Brochure For K058C

O044

Rust & Corrosion Preventive



O004

Superdraulic ISO 46 Hi Temp Hydraulic Oil

