

Product Brochure For K057B

Hydraulic NC Guillotine & NC Pressbrake Package Deal - SG-3206E & PB70B

Guillotine 3200 x 6mm, Pressbrake 3200mm X 70 Ton
 Guillotine Ezy-Set NC-89 Control, Pressbrake Estun NC-21 Control



ORDER CODE:	K057B
MODEL:	SG-3206E & PB-70B
Shearing Capacity - Mild Steel (mm):	6
Shearing Capacity - Stainless Steel (mm):	4
Shearing Length (mm):	3200
NC Control (Type):	~
Backgauge (Type):	~
Backgauge Travel (mm):	600 / 600
Pneumatic Sheet Supports:	~
Quick Action Blade Clearance Adjustment:	Yes
Strokes / min (SPM):	16
Blade Angle (deg):	1° 30
Throat Depth (mm):	125
Motor Power (kW / hp):	7.5 / 10 - 5.5 / 7.5
Voltage / Amperage (V / amp):	415
Floor Space Requirements (L x W x H) (mm):	~
Nett Weight (kg):	5700



Description

MetalMaster Quality Guillotines feature high durability, and provide precision shearing capabilities, The Guillotine main frames are constructed from rolled, stress relieved solid steel to prevent distortion during the shearing process and under extreme continuous loads.

MetalMaster Guillotines are produced in high volume production process and therefore are able to be manufactured cost effectively, resulting in affordable price, representing value for money and quicker return on investment.

This heavy duty over driven style, fixed rake guillotine has been developed for shearing material from mild steel through to stainless steel due to the specially designed shearing blades with characteristics of 1. High resistance to wear, 2. High resistance to corrosion, 3. High resistance to impact & 4. High tensile strength.

All electrical components are of European quality supplied by, Schneider

Rexroth hydraulic control valves.

Features

- SG-3206E GUILLOTINE: 3200 x 6mm
- Ezy-Set NC-89 Go-To digital display control provides up to 600mm travel via leadscrew backgauge allowing operator to program the cut length required. Also incorporated into NC-89 control is a stroke counter and cut length adjustment allowing shorter materials to be cut quicker without blade cycling through full stroke, this feature will increase production.
- Blade gap adjusting dial mounted on side of machine for convenient and accurate alteration for all your material thickness from 0.5 - 6mm. This dial is designed so that a straightforward rotation clock or anti clockwise to achieve desired plate thickness. Measurement on dial indicates and refers to actual blade gap distance in millimetres
- Hydraulic individual sheet material clamping system with nylon inserts to protect material from indentation from the clamping cylinders along full length of machine.
- Transfer balls inserted into work table allowing material to be easily moved to the cut position and squaring arm.
- Top shearing blade made from 6CrW2Si quality composite and has two (2) cutting edges allowing minimised down time in blade rotation.
- Bottom shearing blade made from 6CrW2Si quality composite and has four (4) cutting edges allowing minimised down time in blade rotation.
- The core structure of the steel main frame has been electronically welded ensuring maximum penetration during the manufacturing process. In addition to this feature the cutting beam has been stress relieved eliminating any distortion after manufacturing.
- LED shadow line lighting has been incorporated into the machine frame providing a clear cutting line on the work piece and enabling scribed or marked material to be cut with simplicity as required.
- Heavy duty squaring arm is fitted with a graduated rule and adjustable flip up front stops and mitre guide allowing operator to cut to the required size from the front of machine. Flip over stops can be set to repeat cutting length required with accuracy. The arm also aligns the

Product Brochure For K057B

- material to be located square to the cutting edge.
- Safety three photo electric rear guards fitted to steel side gates ensuring that the machine will be disabled when person enters rear of machine when in use
- Safety reset button for guarding system located at rear of machine, this feature requires operator to walk to rear of machine to visually check for any obstruction prior to resetting & starting machine
- Mild steel capacity is rated on hot rolled material with 250MPA

- Pre-Commissioning:
 1. Guillotine is run & tested prior delivery
 2. Hydraulic oil is included with machine

- PB-70B PRESSBRAKE: 3200 x 70 Ton
- Hydraulic / Mechanical ram, synchronised positive stop design, ram stroke controlled by precision mechanical nut depth stops built into each cylinder. Electronically controlled by Estun NC-E21 digital control assuring accurate repeatability.
- Parallelism is ensured by torsion bar that can be easily adjusted by clutch system.
- Estun E21 programmable digital control stores up to 40 unique programs with 25 automatic progressive bending steps in each individual program, assuring production accuracy & repeatability every time.
- Estun E21 programmable hardened ballscrew backgauge system, simply enter the desired measurement into the controller and press go, the backgauge then will move quickly into the position you have requested. The superior hardened ballscrew system eliminates any backlash that leadscrew type machines produce.
- Segmented heavy duty 35° offset top punch is segmented for return bend clearance, complete with European style punch holder with an adjustable wedge clamping system for crowning. Intermediate clamp has safety key to stop punch dropping.
- Multi vee (V) bottom die is made from one 3200mm solid die block design to handle heavy plate, safety edge vee (V) is incorporated in bottom die block.
- Conveniently mounted control box on pendant for quick swivel and adjustments.
- Mono-block steel frame design, welded then machined to ensure minimal bed deflection under load
- Enclosed rear gate with micro safety switches complete with sliding rear door for easy access.
- European Intermediate clamping system, allowing operator to change position of tooling to suit multiple requirements on complex applications. This feature ensures minimum down time, more productivity and results in reduced cost per finished product.
- Sliding steel fabricated sheet supports enabling a wide range of material sizes to be aligned and supported at the correct required height. This feature is achieved with a "T" slot machined down the total length of the die bed; sheet supports are also adjustable vertically to assist in supporting material with return bends already folded.
- Adjustable sliding blocks control the machines beam to provide desirable open height distance to the (slow speed) mute bending point. Operator adjustable locking knobs for quick adjustment, enables accurate repeatability and increased productivity.
- Metal safety guarding surrounding the machine with rear sliding door fitted and micro switch ensuring operator safety. Clear access panels placed at each end of machine allows the operator to clearly view tooling and work piece during bending operation. MetalMaster specially design gates to suit Australian safety requirements.
- Hydraulic MPA pressure gauge mounted on right side of support frame with quick adjusting pressure control knob allowing operator to accurately set the pressure required for different material thickness, incorporating with hydraulic overload protection.
- Welded steel fabricated synchronised torsion bar horizontally supporting main bending beam to provide consistent parallelism that also can be adjusted for taper correction.
- The vertical supporting slides are treated to provide greater wear resistance and increased accuracy.
- Includes safety control guarding system with light curtains fitted
- Mild steel capacity is rated on hot rolled material with 250MPA

- Pre-Commissioning:
 1. Pressbrake bender is run & tested prior delivery
 2. Hydraulic oil is included with machine

Includes

- SG-3206E GUILLOTINE:
 - Heavy duty over driven machine construction
 - Rapid blade gap adjustment
 - Emergency stops fitted on both ends of machine for additional safety
 - Individual hydraulic hold downs with nylon pads
 - 125mm throat enables shearing of longer material than 3200mm
 - Shadow line lighting allows operator to quickly see the cut line
 - 600mm Ezy-Set NC-89 Go-To via leadscrew backgauge with fine adjustment
 - Swing away backgauge function for cutting long sheets
 - 4 edge quality 6CrW2Si blades suitable for stainless steel
 - Rexroth hydraulic control valves
 - Schneider electrical components
 - Transfer balls on table & support arms
 - Heavy duty support arms and squaring arms
 - Stroke counter and short stroke adjustment
 - Sliding chute fitted, easily allowing operator to retrieve cut pieces
 - Three safety photo electric light beams on rear guarding

- PB-70B PRESSBRAKE:
 - Swivel pendant control unit operated by Estun NC-E21 control
 - LED superior bright work lights provides clearer view to workpiece
 - Sliding front sheet support arms
 - Emergency stop buttons conveniently located on control panel and foot control
 - Mobile dual operation foot control
 - Segmented 35° offset top punch
 - Solid one piece four way multi vee (V) die block
 - Top punch tool intermediate holder system with wedge type adjustment
 - Powered hardened ballscrew backgauge with 600mm travel, operated by Estun NC-E21 control

Product Brochure For K057B

- Oil tank level indicator
- Metal constructed safety guarding surrounding machine with clear side viewing panels
- Integrated hydraulic system allowing rapid approach switching automatically to slow bend

Specific Features



SG-3206E Guillotine



Right View



Squaring Arm



NC89 Control



NC Leadscrew Backgauge



NC Leadscrew Backgauge System



Material Transfer Balls on the Table



Blade Clearance Adjustment Lever

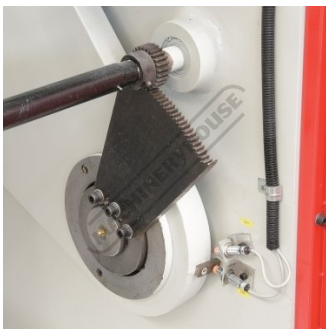

Blade Clearance Adjustment Mechanism



Rear Guarding View



3 x Rear Light Sensor Guarding System



Safety Omron E3ZS Rear Light Sensor Guarding



Rear Guard Rest Button



Adjustable Blade Beam Return Pressure



Pressurized Beam Return Tank



Foot Control

Product Brochure For K057B



Emergency Stop



Lifting Point



PB-70B Pressbrake



E21 New NC Programmable Controller



E21 New Estun



Adjustable Travel Limit Control



Enclosed Rear Safety Guarding

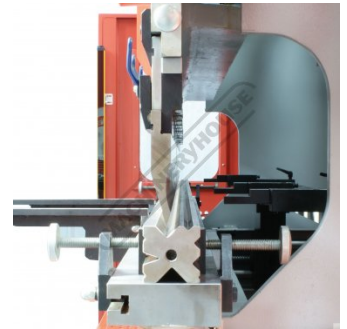

Top and Bottom Tooling



Intermediate Clamps



Adjustable and Sliding Front Sheet Supports



Adjustable Pressure Control



Estun NC E21 Control Back Gauge



Mobile Foot Control



Controller Top View

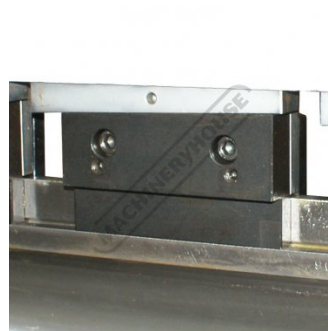

Adjustable Top Tool Taper Wedge System



Fine Adjustment Beam Positioning

Product Brochure For K057B



Fine Adjust Back Gauge



Synchronised Torsion Bar



Synchronised Torsion Bar

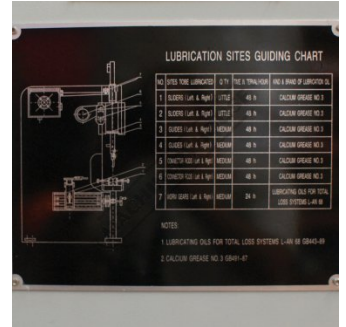

Lubrication Chart

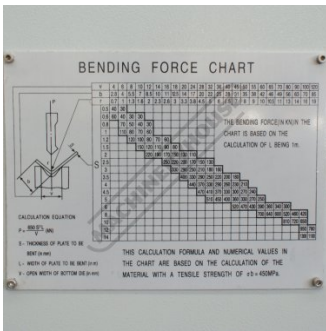

Tonage Calculation Chart

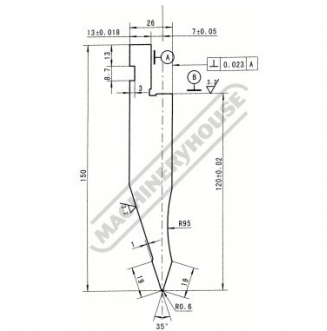

Segmented Top Punch

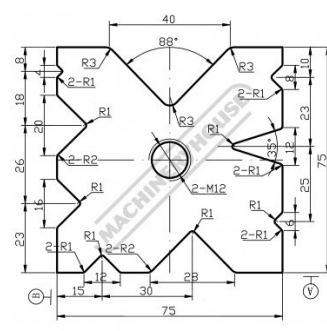

One Piece 4 Sided Die

Recommended Accessories

S9991
 3200mm Sheet Metal Guillotine
 Blade Set - 6CrW2Si

M800
 Rubber Mat - Anti-Fatigue

M805
 Rubber Mat - Anti-Fatigue

O000
 SpillFix Universal Organic
 Absorbent

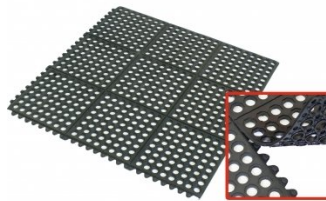
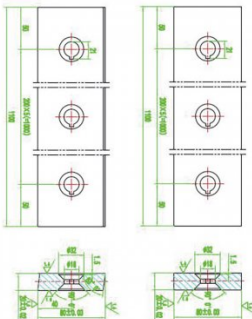

Product Brochure For K057B

O043
 Rust & Corrosion Preventive



O042
 General Purpose Lubricant & Corrosion Inhibitor



O040
 Rust & Corrosion Preventive



O044
 Rust & Corrosion Preventive



O004
 Superdraulic ISO 46 Hi Temp Hydraulic Oil

