

Product Brochure For C256A

4 Jaw Independent Lathe Chuck - K72-320/D1-8

Ø320mm

D1-8 Camlock Mount

Ex GST
\$590.00

Inc GST
\$649.00



| | |
|-------------------|-------|
| ORDER CODE: | C256A |
| Chuck Size (mm): | Ø320 |
| Camlock: | D1-8 |
| Speed (rpm): | 1200 |
| D1 (mm): | 139.7 |
| D2 (mm): | 171.4 |
| D3 (mm): | 95 |
| H1 (mm): | 90 |
| h (mm): | 14 |
| Nett Weight (kg): | 40.5 |

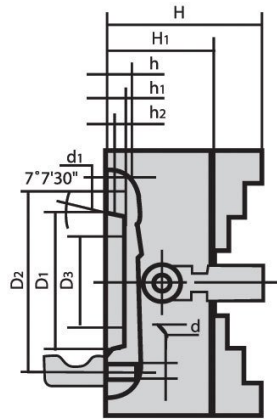

Description

Manufactured from High Strength semi steel and precision machined
 Jaws are case-hardened to minimise wear
 Operating screws are made from alloy steel and case-hardened.
 Supplied with camlock pins, 1 set of jaws and wrench.

Product Brochure For C256A

Specific Features



Camlock Mount



Included Accessories



Front View

Recommended Accessories

A358
 Sky Hook Lifting Device

A358A
 Chuck Hook

A358B
 Choker Collar

A358C
 Bolt Down Adaptor

