

Product Brochure For C251

## 4 Jaw Independent Lathe Chuck - K72-200

Ø200mm  
 Back Plate Mount

Ex GST \$220.00  
 Inc GST \$242.00



ORDER CODE:	C251
Chuck Size:	Ø200
External Jaw Range (mm):	130 - 200
Internal Jaw Range (mm):	4 - 90
Speed (rpm):	2000
D1 (mm):	80
D2 (mm):	112
D3 (mm):	70
H1 (mm):	71
h (mm):	6
z-d (mm):	4 - M10
Nett Weight (kg):	15



### Description

Manufactured from High Strength semi steel and precision machined  
 Jaws are case-hardened to minimise wear  
 Operating screws are made from alloy steel and case-hardened

### Features

- Front Mounting

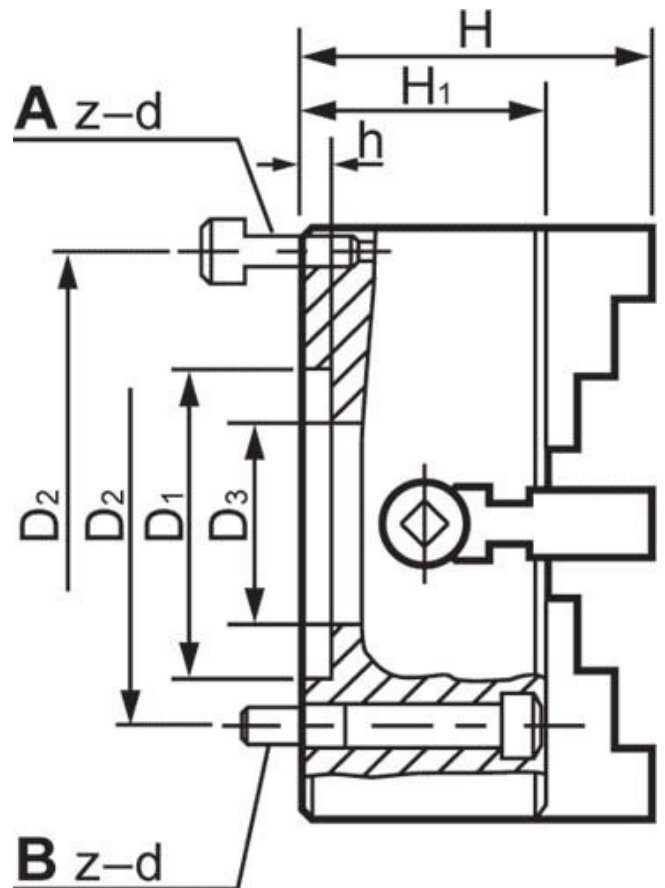

Product Brochure For C251

**Specific Features**



Back Plate Mount



Included Accessories



Front View

**Recommended Accessories**

L287

D1-4 Camlock Back Plate



L2875

D1-5 Camlock Back Plate



L289

D1-6 Camlock Back Plate



L286

D1-8 Camlock Back Plate



L2884

D1-11 Camlock Back Plate

