

Product Brochure For H270

Electric Winch - CP250

250kg Lifting Capacity
 30 Metre Lifting Height



ORDER CODE:	H270
Model:	CP250
Load Capacity (kg):	250
Cable Length (Metre):	30
Speed (m/min):	10 - 15
A (mm):	6 - Ø10.5
B (mm):	142
C (mm):	142
D (mm):	548
E (mm):	210
F (mm):	241
Nett Weight (kg):	34

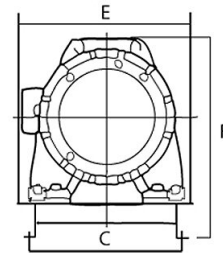
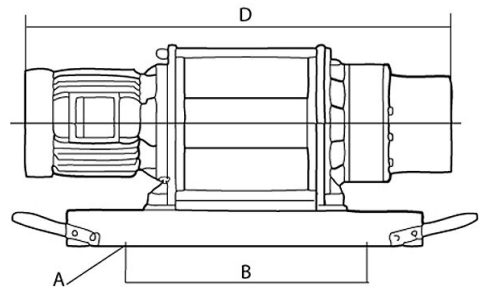

Description

EXTREMELY RUGGED, LIGHTWEIGHT WINCHES FOR FACTORIES, BUILDING SITES, SLIPWAYS

Also Available
 - 12V/24V/240V and 415V available
 - 200kg to 3000kg

Features

- High starting torque motors
- Electric safety brake
- Heavy gearbox
- Quiet operation
- Push button, forward and reverse
- Ø6mm wire rope, 30 metres long
- 29 metres max. lifting height

Optional Accessories

- Other Model Available, Please Contact Store For More Details